



Rockaway Parks Conceptual Plan Community Board Meeting

Presentation of Draft Concept Designs for
Review and Comment

March 24, 2014

Parks

GOALS FOR THE CONCEPTUAL PLAN

- 1. Develop a plan for a comprehensive park system in the Rockaways**
- 2. Complement the Rockaway Boardwalk Plan**
- 3. Establish investment goals for parks and open space**
- 4. Integrate resiliency into Parks' plans**
- 5. Develop specific ideas and designs for particular parks**



PROJECT SCHEDULE

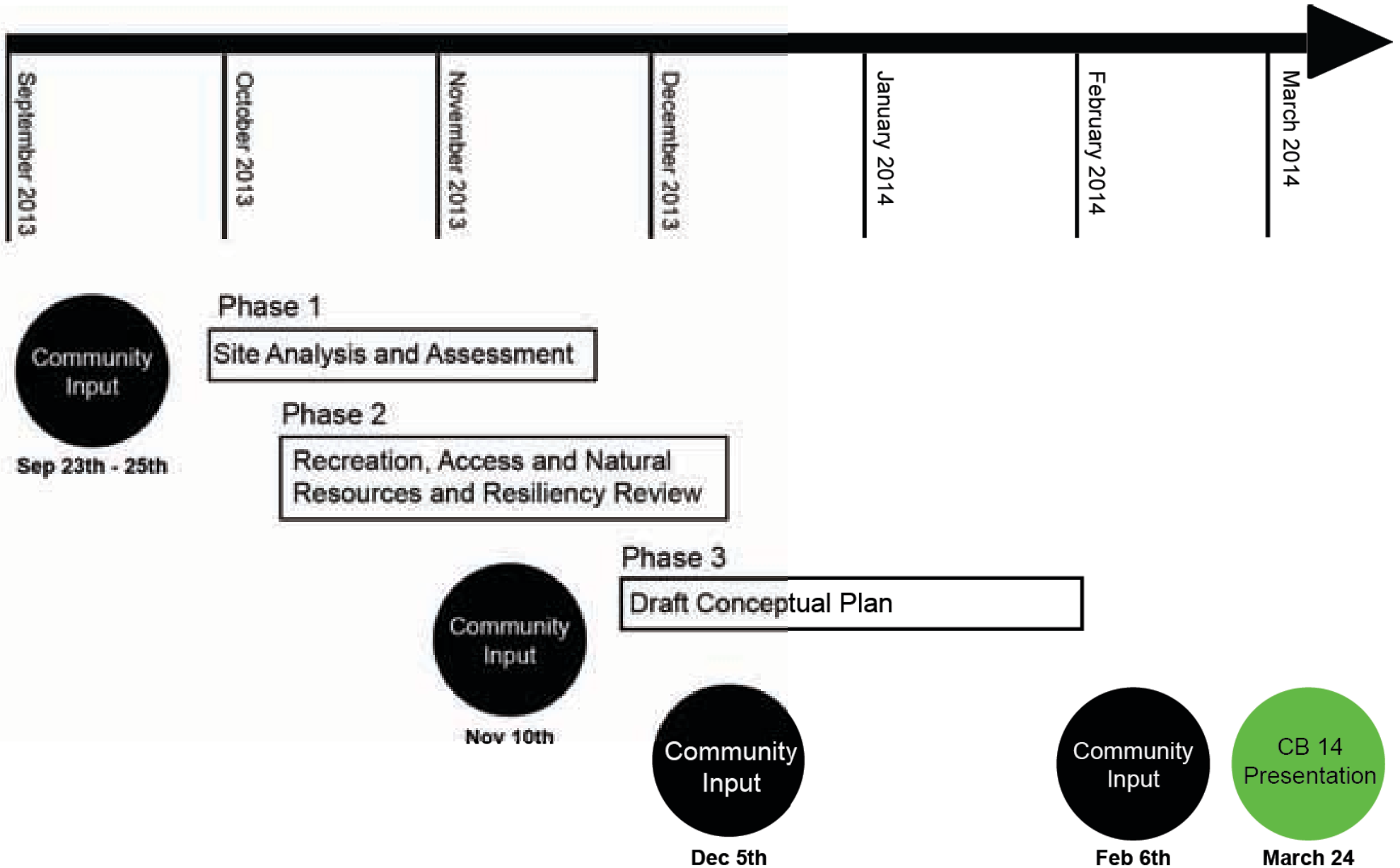

STUDY AREA



Sunset Cove Park & Broad Channel American Park Study Area



OPPORTUNITY SITES OVERVIEW

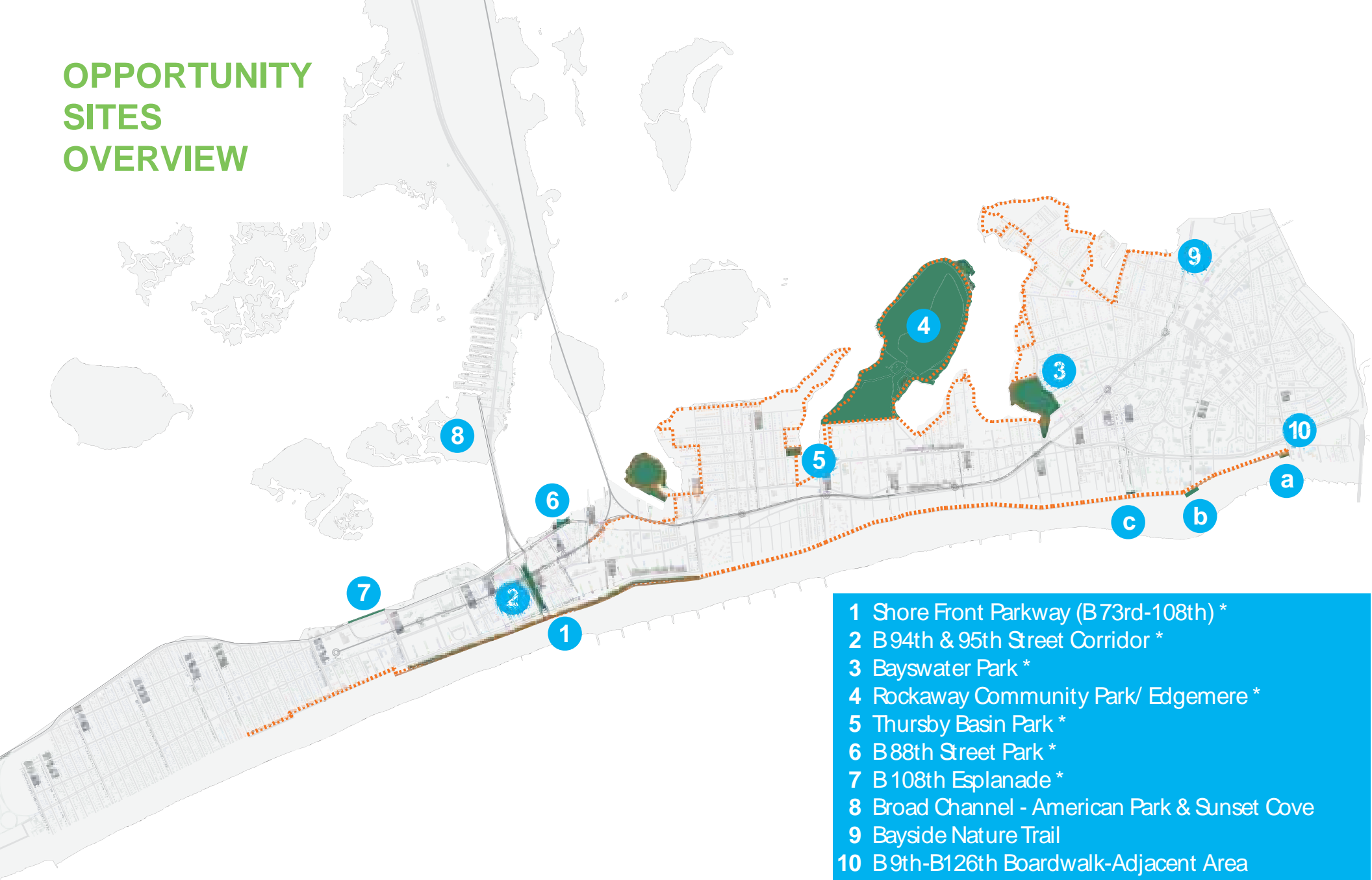

- 1 Shore Front Parkway (B 73rd-108th) *
- 2 B 94th & 95th Street Corridor *
- 3 Bayswater Park *
- 4 Rockaway Community Park/ Edgemere *
- 5 Thursby Basin Park *
- 6 B 88th Street Park *
- 7 B 108th Esplanade *
- 8 Broad Channel - American Park & Sunset Cove
- 9 Bayside Nature Trail
- 10 B 9th-B126th Boardwalk-Adjacent Area
 - a B 9th Seating & Play Area (Unbuilt PlaNYC)
 - b B 20th Overlook (Unbuilt PlaNYC)
 - c B 26th-27th Park Area (Unbuilt PlaNYC)

* Parks for which conceptual design cost estimates have been prepared



Shore Front Parkway Beach 73 - 108 Street

Detailed print outs of this concept design will be available at tables after presentation



Shore Front Parkway Beach 106 - 108 Street

Sample Section

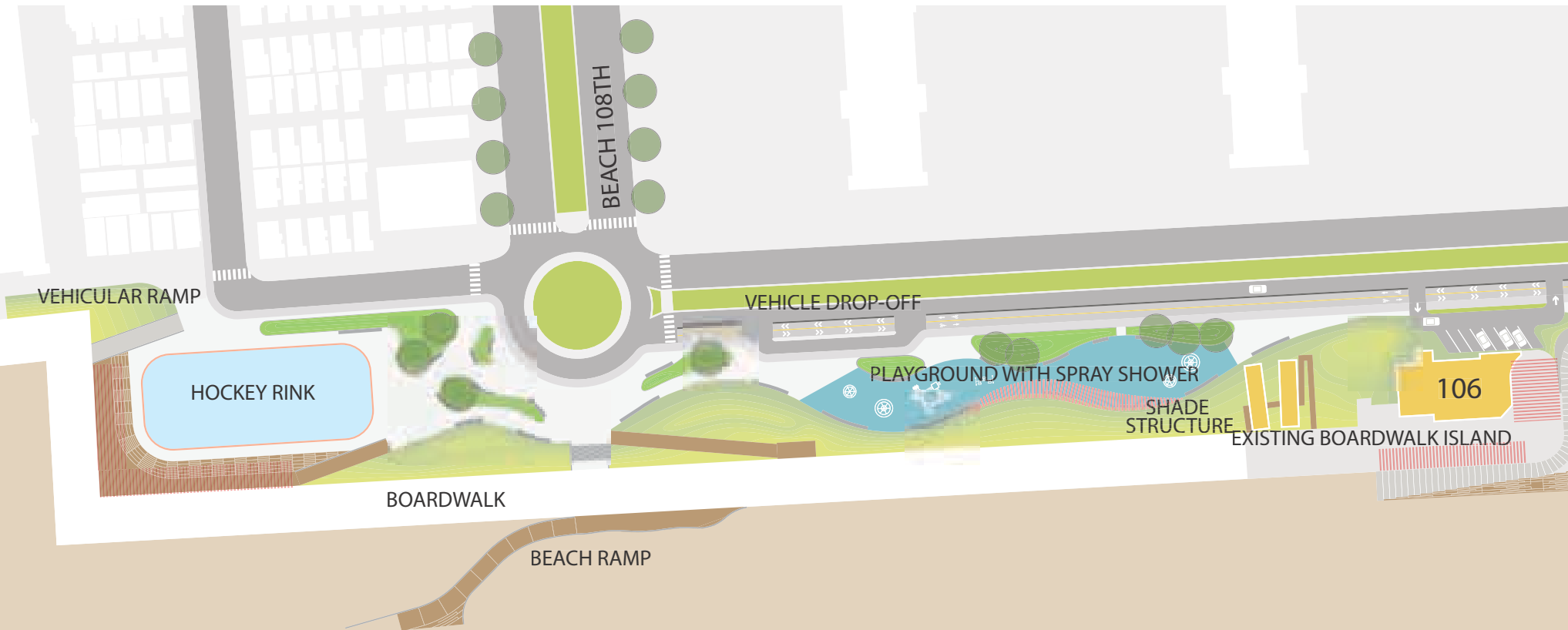

Shore Front Parkway Beach 93 - 98 Street

Sample Section



Shore Front Parkway Beach 94 - 95 Street Plaza



Shore Front Parkway Beach 86 - 93 Street

Sample Section

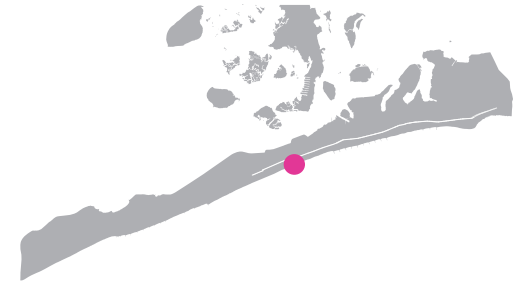

Shore Front Parkway Skate Plaza



Beach 94th & 95th Street Corridor

Total Park Cost: \$12 - 15 M



Beach 94th & 95th Street Corridor

Market Scenario:



1

Markets



2

Outdoor cafe with seating



3

Events

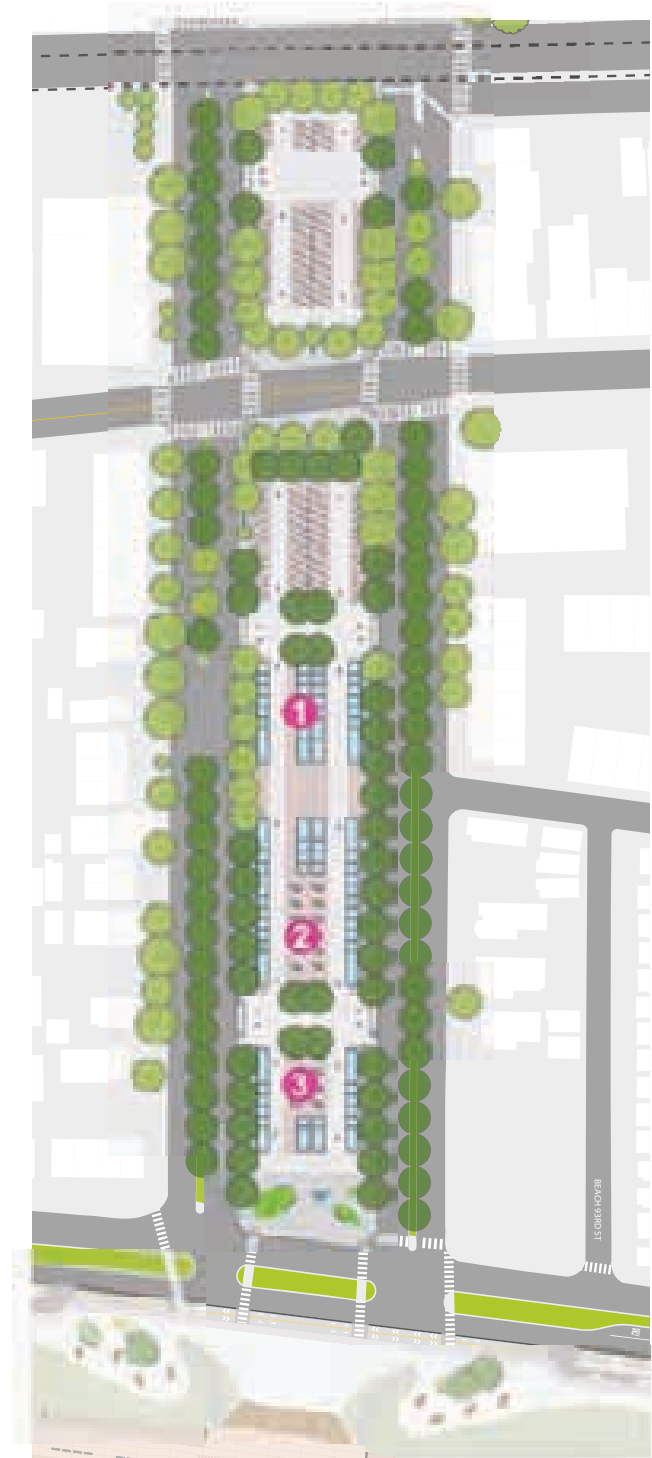

Beach 94th & 95th Street Corridor



Photomontage viewing north at the intersection of Shore Front Parkway and Beach 94th Street



Bayswater Park

Total Park Cost: \$26-29 M

New Facilities:

- 1 Public Art Plaza
- 2 Boat Shed \$1.25-1.75M
- 3 Kayak Launch
- 4 Running Track
- 5 BBQ and Picnic Area
- 6 Skate Area \$200-300K
- 7 Permanent Event Stage
- 8 Baseball Field (1)
- 9 Cricket Field (1)
- 10 Soccer Field (1) \$1-1.25M
- 11 Tennis Courts (3)
- 12 Junior Tennis Courts (2)
- 13 Basketball Courts (3)
- 14 Handball Courts (6)
- 15 Playground \$560-875K
- 16 Toddler Playground \$300-500K
- 17 Water Jets
- 18 Improved Crossing (DOT to review)
- 19 Refurbished Comfort Station \$.75-1.25M

All costs are draft estimates for specific amenities only and do not account for other necessary infrastructure



Bayswater Park



Rockaway Community Park/ Edgemere

New Facilities:

- 1 Future Park (to be reviewed with DSNY)
- 2 Rockaway Community Park



Rockaway Community Park

Total Park Cost: \$25-28 M

New Facilities:

- 1 Playground
- 2 Turf Field
- 3 Comfort Station and Park Kiosk \$0.75-1.25M
- 4 Skate Plaza \$0.75-1.25M
- 5 Kayak Landing Point
- 6 BBQ and Picnic Areas
- 7 Pier
- 8 Cricket Field (1)
- 9 Soccer Field (1)
- 10 Tennis Courts (4)
- 11 Basketball Courts (3)
- 12 Handball Courts (2)
- 13 Gaming Area: Ping Pong, Shuffleboard (1)
- 14 Restored Wetlands
- 15 Restored Upland Forest
- 16 Paved Path
- 17 Community Garden
- 18 Wetland Boardwalk \$400-600K
- 19 Refurbished Comfort Station \$400-600K

All costs are draft estimates for specific amenities only and do not account for other necessary infrastructure

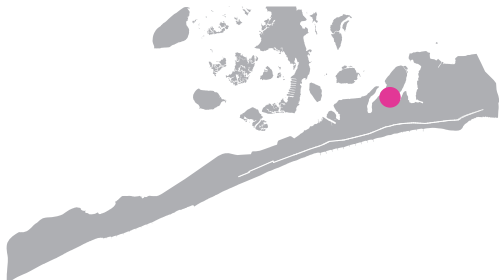

Rockaway Community Park



Photomontage looking northwest at proposed new section of Rockaway Community Park. View taken from intersection of Beach 49th Street and Norton Drive.



Rockaway Community Park

New Facilities:

- Mosquito Magnets

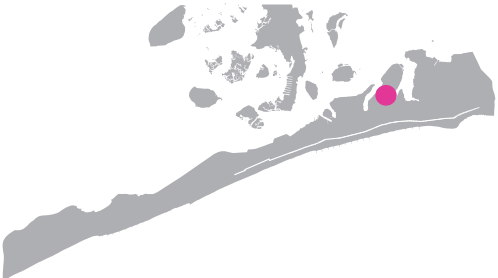

Thursby Basin Park

Park Cost: \$8-10M

New Facilities:

- | | | | |
|---|--------------------|----|--------------------------|
| 1 | Comfort Station | 7 | Open Lawn |
| 2 | Shade Structures | 8 | Rain Garden |
| 3 | Adult Fitness Area | 9 | Riparian Planting/Riprap |
| 4 | Playground | 10 | Lawn |
| 5 | BBQ Area | 11 | Bermed Lawn |
| 6 | Waterfront Seating | | |

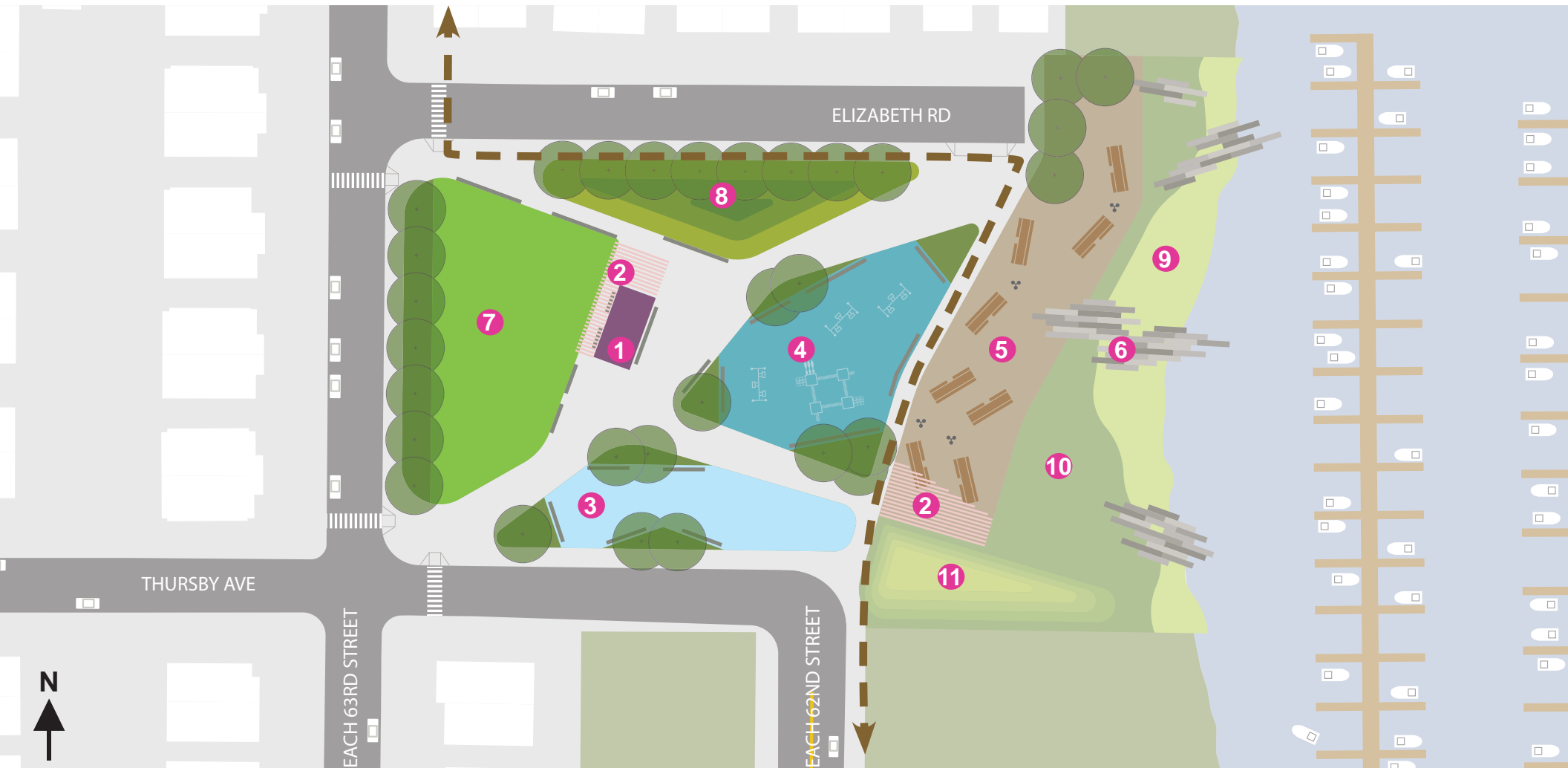
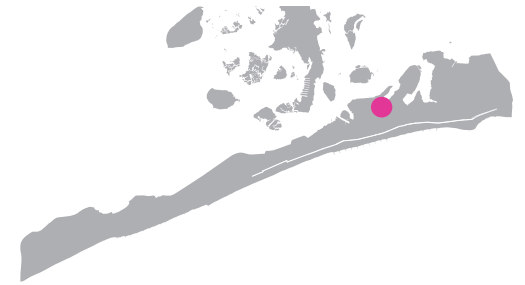

Thursby Basin Park



Photomontage looking east from proposed picnic area towards the Thursby Basin Waterfront with Rockaway Community Park across the water in the distance.



Beach 88th Street Park

Park Cost: \$7-8M

New Facilities:

- | | | |
|------------------------------|-------------------------|---|
| 1 Comfort Station | 6 Picnic and BBQ | 12 Improved Crossing
(DOT to review) |
| 2 Kayak Storage | 7 Open Lawn | |
| 3 Beach with Kayak
Launch | 8 Playground | |
| 4 Shade Structures | 9 Oyster Reef | |
| 5 Pier | 10 Restored Wetlands | |
| | 11 Upland Riparian Zone | |

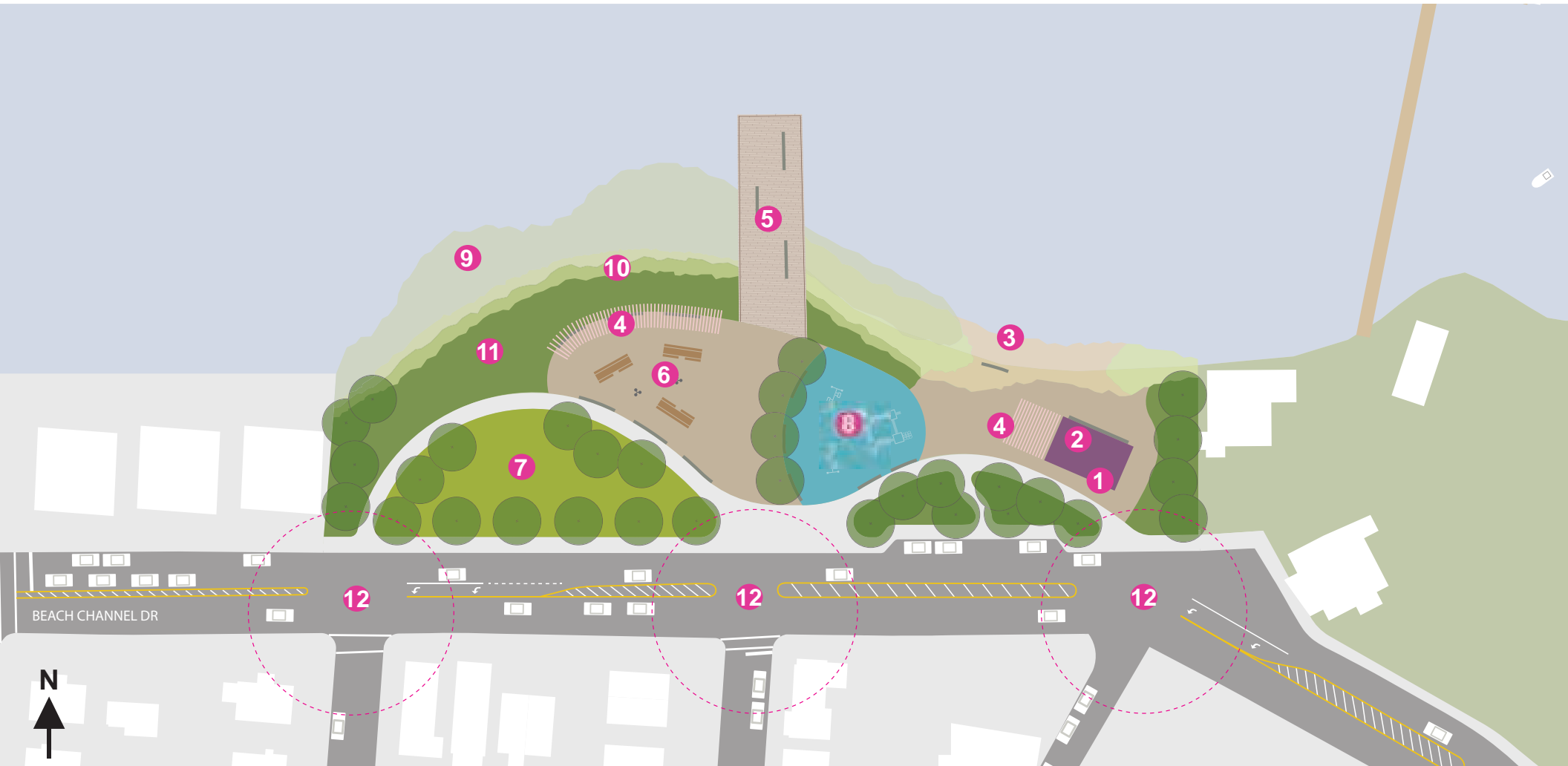

Beach 88th Street Park



Photomontage looking northwest from proposed kayak launch towards new fishing pier.
(Rendering will be updated to reflect existing DEP infrastructure)

Beach 108th Esplanade

Park Cost: *to be
Funded by National
Grid*

New Facilities:

- 1 Esplanade
- 2 Landscape Buffer
- 3 Possible Ferry Pier

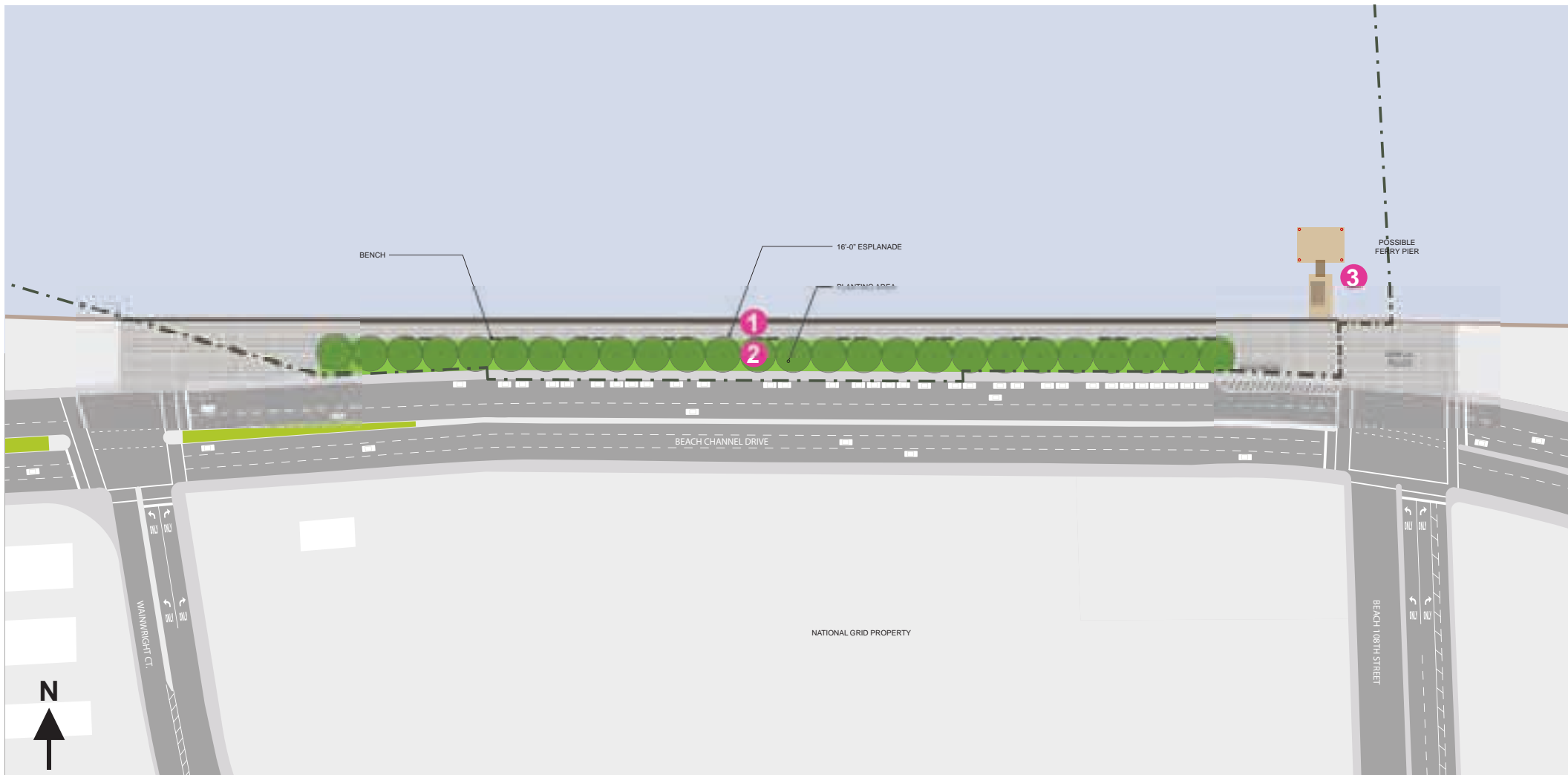

Beach 108th Esplanade

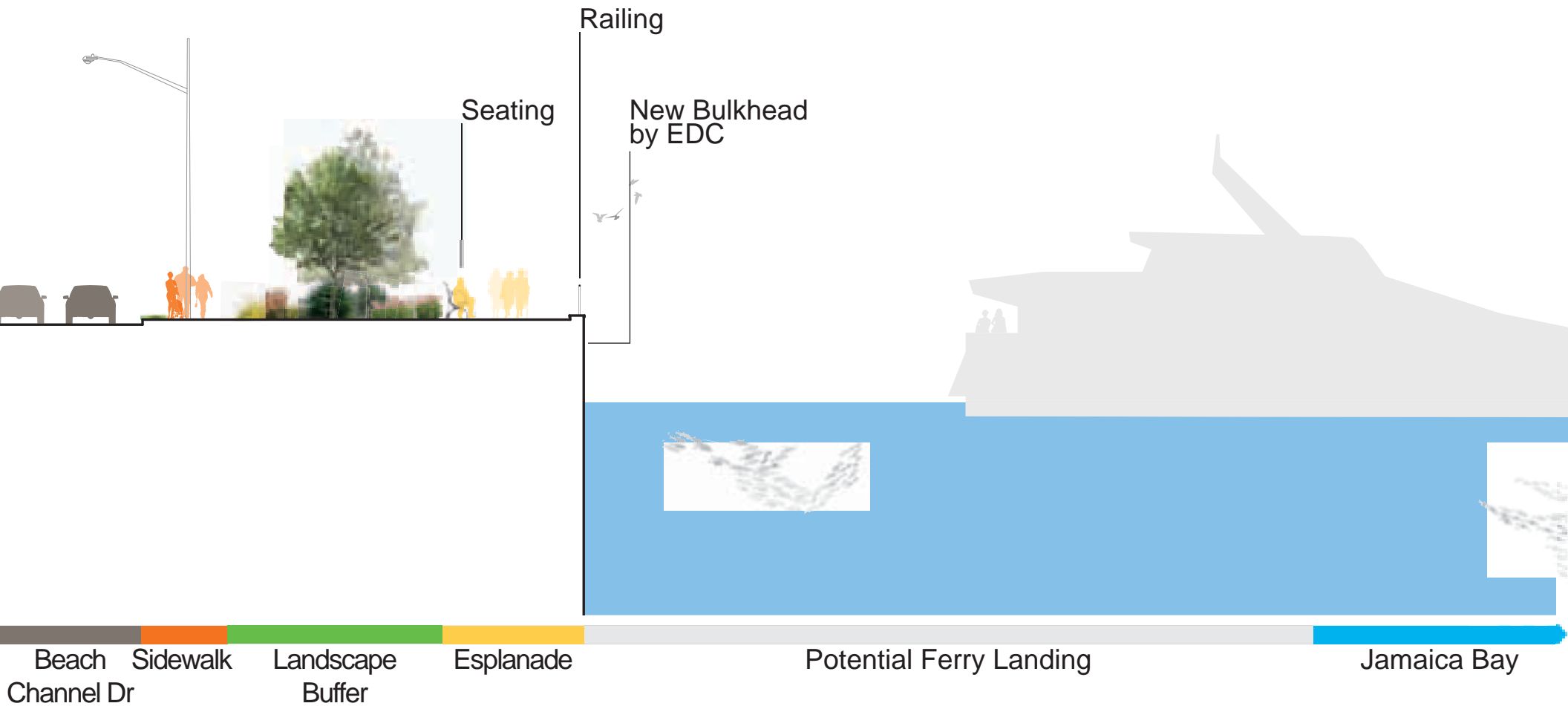

Broad Channel - American Park & Sunset Cove



Key Features:

- 1 Oyster Revetment Installation (NY Rising)
- 2 Salt Marsh Habitat Restoration
- 3 Scrub-Shrub Forest Trail
- 4 Stormwater Bio-swales
- 5 Location of Possible Community Center
- 6 Park Entrance from Cross Bay Blvd
- 7 Upgraded Parking Lot
- 8 Elevated Comfort Station & Field House
- 9 Primary Walking/Jogging Path
- 10 Tot Lot
- 11 Multi-purpose Field
- 12 Nature Path on NPS Land
- 13 Skate Features
- 14 Shade Structure
- 15 Baseball Field (Upgraded)
- 16 Baseball Field (Existing)
- 17 Beach Nourishment
- 18 Designated Fishing Zone
- 19 Access for Canoes & Kayaks

For future discussion with the Broad Channel Civic Association, next meeting on March 27th

ROCKAWAY PARKS CONCEPTUAL PLAN



NYC Parks

REGIONAL OPPORTUNITIES

8. Bayside Nature Trail





9. Boardwalk-Adjacent Area

- a. Eastern B 9th Seating and Play Area (Unbuilt PlaNYC Park)**
- b. B 20th Overlook (Unbuilt PlaNYC Park)**
- c. B 26th-27th Park Area (Unbuilt PlaNYC Park)**



Bayside Nature Trail

Park Cost: \$5-6M

-  Kayak/Canoe Launch
-  Street-End Park
-  Fishing Access
-  Bird Blind
-  Hiking/Nature Trail

Existing Path: 3.61mi
Proposed Path: 2.44mi

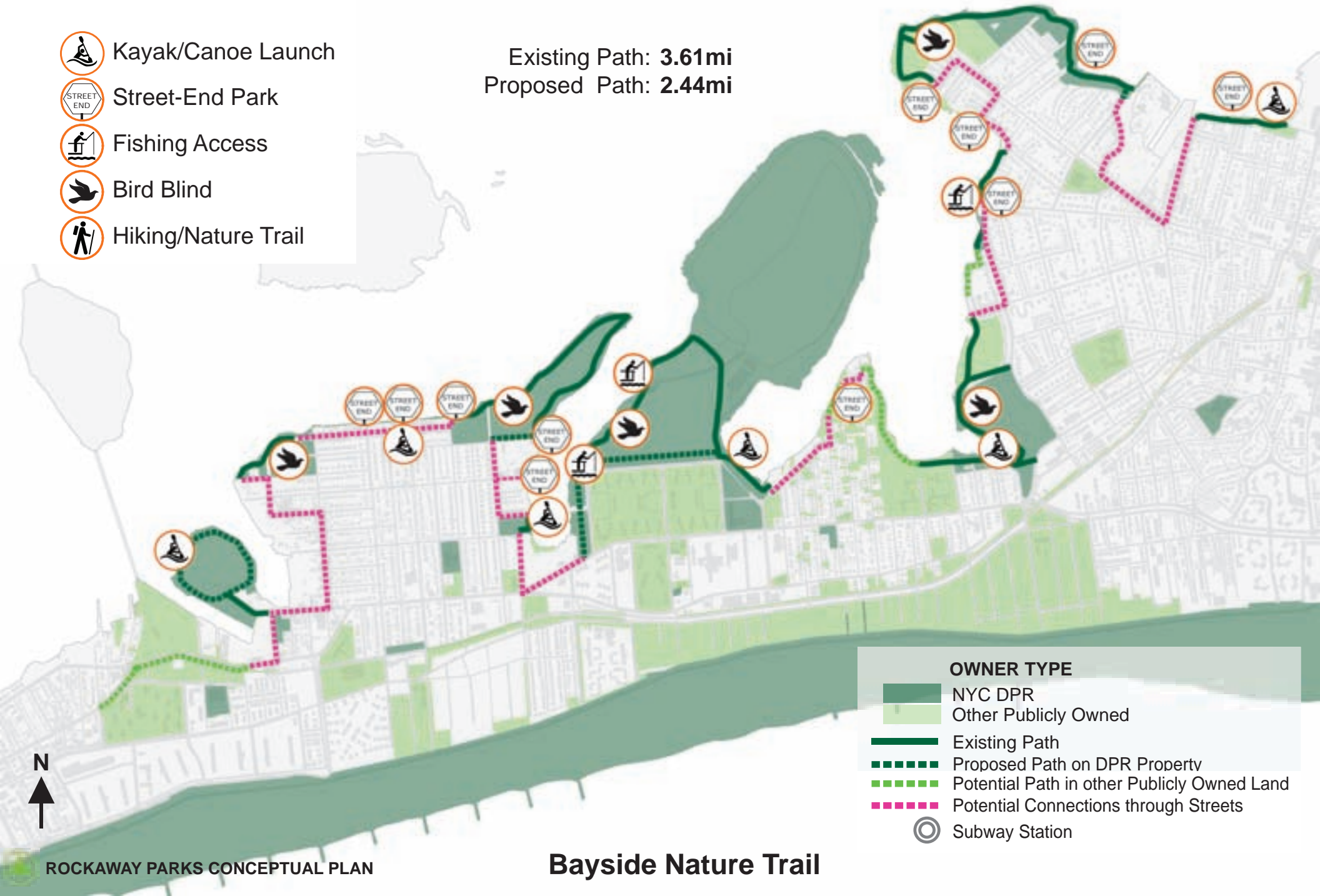

Bayside Nature Trail

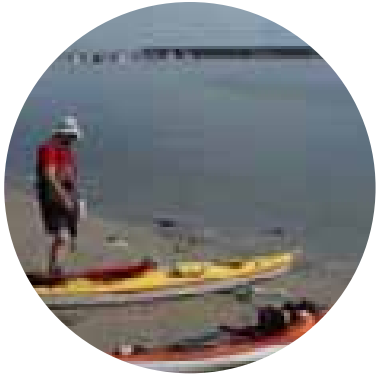

Kayak/Canoe Launch

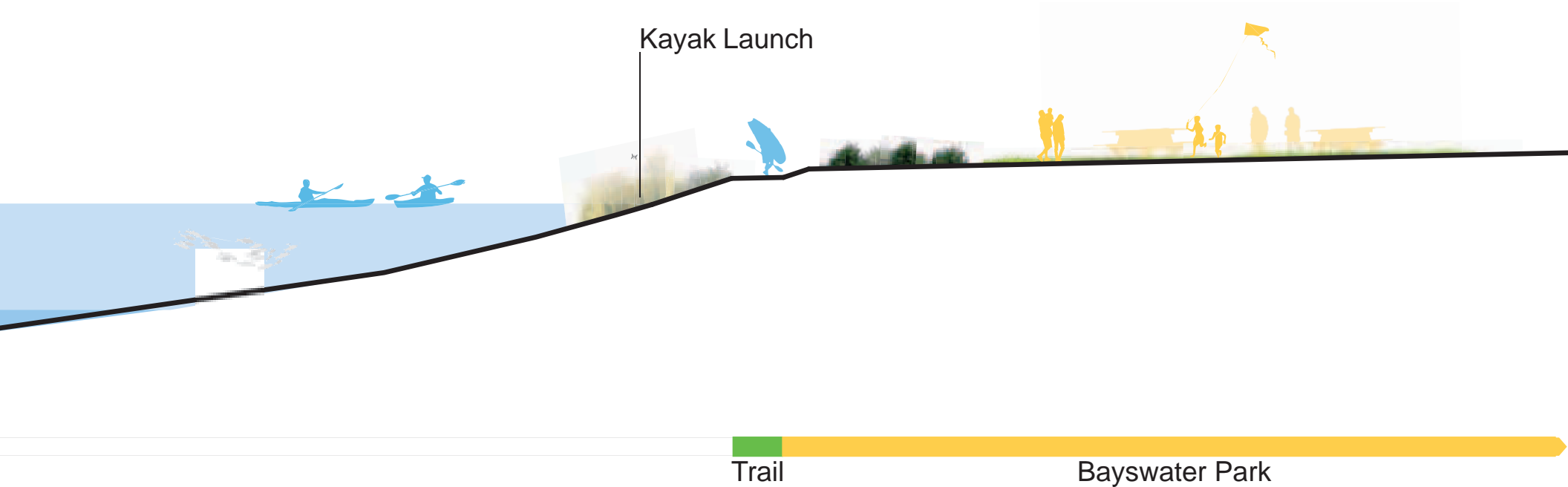

Bayside Nature Trail

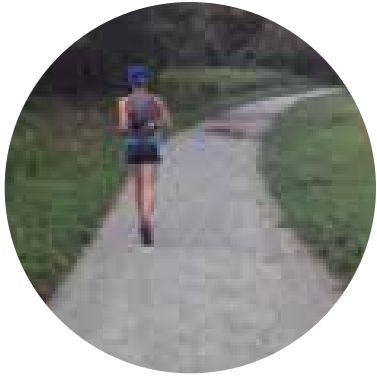

Hiking/Nature Trail

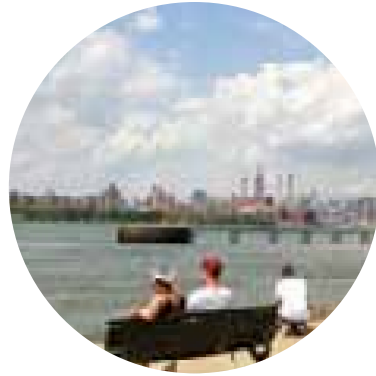

Street-End Park



Raised Berm



Trail

Sidewalk

Street

Sidewalk

Ocean Bay
Apartments



Bayside Nature Trail



Photomontage looking south to the proposed Bayside Nature Trail in Rockaway Community Park along Beach 58th Street and Thursby Basin.



Eastern Boardwalk Adjacent Park Opportunities

Cost: \$1.3M
B 26th-27th



Cost: \$2.7M
B 20th Overlook



Cost: \$2.6M
B 9th Seating/Play Area



NEXT STEPS CLOSING REMARKS

- **Complete the Conceptual Plan**
 - Revise Plan based on community feedback
 - Brief stakeholders
 - Release Final Report in Spring 2014
- **Secure Funding for Implementation**
 - The Conceptual Plan will be implemented in phases as funds are secured
 - Final Plan will identify funding needs for various components of the Plan
 - We look forward to your participation in making this project a reality
- **Design and Construct Projects**



NEXT STEPS

- **Blow-up concept designs for each site will be available for viewing at tables**
- **We would like to hear your feedback on designs and priority of sites**
- **In addition, you can email your comments to:**
rockawayconceptualplan@parks.nyc.gov
- **Please submit all comments by Friday, March 28th**

